



Quick Installation Guide

AC750 Wi-Fi Travel Router

TL-WR902AC



Set up with videos

Scan the QR code, or visit
<https://www.tp-link.com/download/TL-WR902AC.html#videos>

© 2023 TP-Link 7106510277 REV4.0.0

Determine Operation Mode

Refer to the following scenarios to determine an appropriate operation mode.

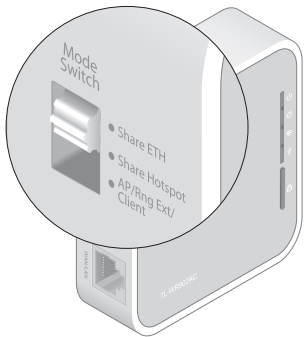

Scenario	I Want To...	Operation Mode	Mode Switch
During Travel	The wired network is only limited to one device to connect at a time and I want to share the internet with more wireless devices.	Router (Default Mode)	Share ETH
	I want to turn existing public Wi-Fi into a private network (wired and wireless).	Hotspot	Share Hotspot
At Home	I want to turn the existing wired-only network into a wireless network.	Access Point	AP/Rng Ext/Client
	I am in a Wi-Fi "dead zone" or a place with weak wireless signal. I want to expand an existing Wi-Fi network for a better internet connection.	Range Extender	
	I have a wired-only device, for example, a smart TV, media player, or game console. I want to connect it to a Wi-Fi network.	Client	

During Travel

Router Mode

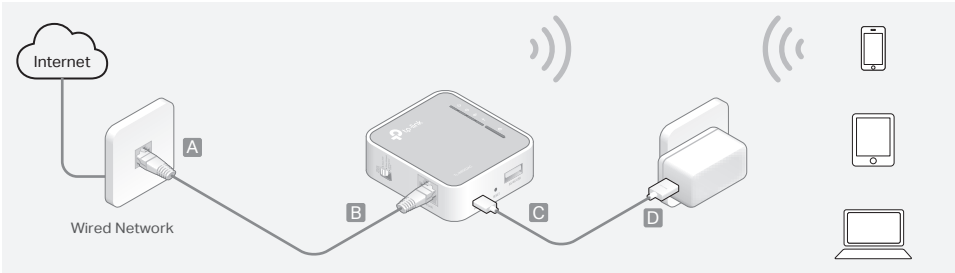

- Switch the Mode Switch to **Share ETH** and connect the hardware from Step A to D.
Tip: If you are using a 3G/4G USB modem with a SIM/UIM card, plug the USB modem into the 3G/4G USB port to transfer the 3G/4G signal to Wi-Fi.

- Connect your device to the router's Wi-Fi. The default SSID (network name) and Wireless Password are printed on the label at the back of the router.

Wireless Password /PIN	XXXXXXXX
SSID	2.4G: TP-Link_XXXX 5G: TP-Link_XXXX_5G

- Check whether the Internet LED  is on.
- If yes, skip to Step 6.
- If no, continue with the steps below.

- Launch a web browser and enter <http://tplinkwifi.net> in the address bar. Create a password to log in.

[←](#) [→](#) [↗](#)

Password

Confirm Password

Start

- Click **Next** to start the Quick Setup and then follow the step-by-step web instructions to set up the internet connection.

- Notes:
- If you are not sure about your **WAN Connection Type**, click **Auto Detect**.
 - You can customize your **Wireless Network Name** and **Password** for the 2.4GHz/5GHz wireless network during the Quick Setup, but you need to reconnect your wireless devices to the new Wi-Fi network(s).
- Connect your own devices to the router's Wi-Fi to enjoy the internet. The WAN/LAN port functions as the WAN port in this mode.

Hotspot Mode

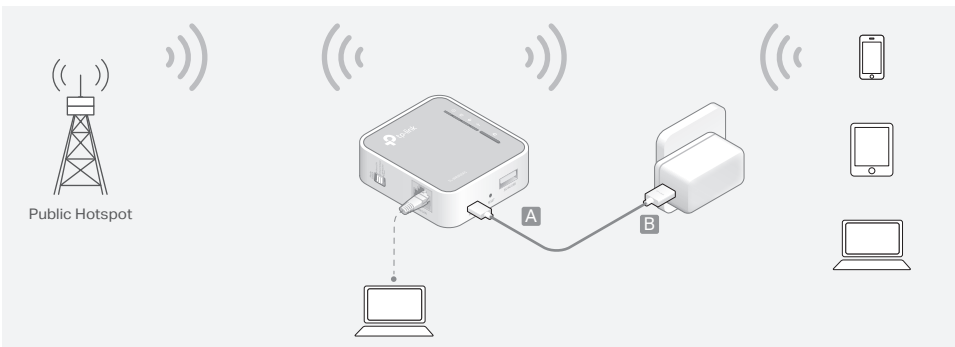

- Switch the Mode Switch to **Share Hotspot** and connect the hardware from Step A to B.
- Connect your device to the router wirelessly or via an Ethernet cable. The default SSID (network name) and Wireless Password are printed on the label at the back of the router.

Wireless Password /PIN	XXXXXXXX
SSID	2.4G: TP-Link_XXXX 5G: TP-Link_XXXX_5G

- Launch a web browser and enter <http://tplinkwifi.net> in the address bar. Create a password to log in.

[←](#) [→](#) [↗](#)

Password

Confirm Password

Start

- Click **Next** to start the Quick Setup and then follow the step-by-step web instructions to set up the internet connection.

- Notes:
- If you are not sure about your **WAN Connection Type**, use **Dynamic IP** in most cases or consult the ISP.
 - You can customize your **Local Network SSID** and **Password** for the 2.4GHz/5GHz wireless network during the Quick Setup, but you need to reconnect your wireless devices to the new Wi-Fi network(s).
- Connect your own device to the router wirelessly or via an Ethernet cable to enjoy the internet. The WAN/LAN port functions as the LAN port in this mode.

Hardware Information



LED	Status	Indication
	On/Off	The router is on or off.
	Blinking	The router is initializing or being upgraded.
	On/Off	The internet is available or unavailable.
	Blinking	The WAN/LAN port is connected but internet is unavailable when in Router or Access Point mode.
	On	The wireless network is enabled.
	Blinking	The router is connecting to the host network when in Range Extender or Client mode.
	Off	The wireless network is disabled.
	On	A USB device is connected.
	Off	No USB device is connected.
	On	This light stays on for 5 minutes when a WPS connection is established, then goes off.
	Blinking	WPS connection is in progress.
	Off	No WPS connection is established.

Item	Description
Mode Switch	This switch is used to change the operation mode of the router.
WAN/LAN Port	This port functions as the WAN port in Router mode and as the LAN port in Hotspot, Range Extender and Client modes. This port is for connecting to the existing router in Access Point mode.
POWER Port	The port is used to connect the power adapter.
RESET Button	To reset the router, use a pin to press and hold the button until all the LEDs turn off.
3G/4G USB Port	This port is used for plugging in a 3G/4G modem or USB drive.
(WPS Button)	To establish WPS connection, press this button.

• Access Point Mode

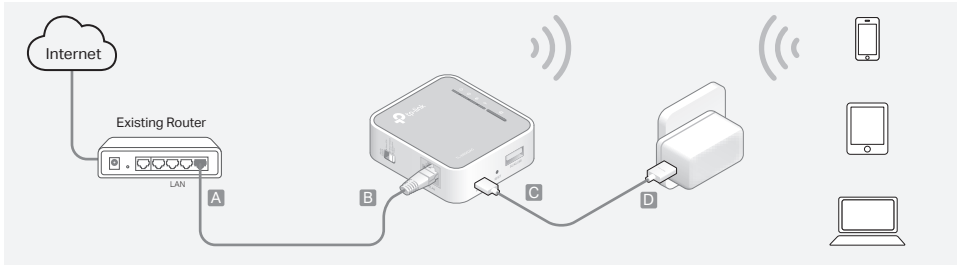

1. Switch the Mode Switch to **AP/Rng Ext/Client** and connect the hardware from Step A to D.
2. Connect your device to the router's Wi-Fi. The default SSID (network name) and Wireless Password are printed on the label at the back of the router.

Wireless Password /PIN	XXXXXXXX
SSID	2.4G: TP-Link_XXXX 5G: TP-Link_XXXX_5G

• Range Extender Mode

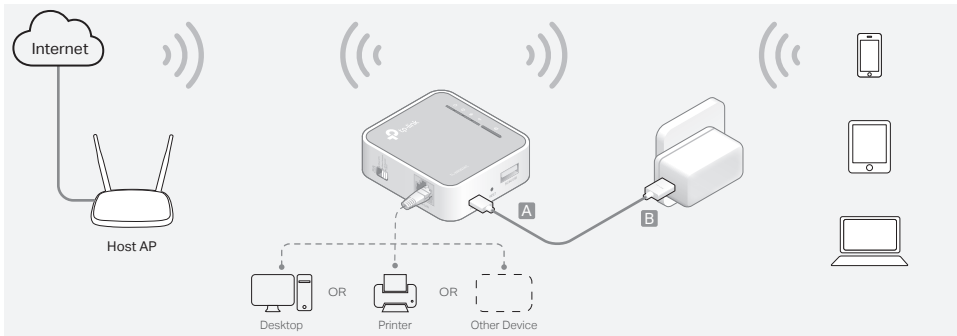

1. Switch the Mode Switch to **AP/Rng Ext/Client** and connect the hardware from Step A to B near your host AP.
2. Connect your device to the router wirelessly or via an Ethernet cable. The default SSID (network name) and Wireless Password are printed on the label at the back of the router.

Wireless Password /PIN	XXXXXXXX
SSID	2.4G: TP-Link_XXXX 5G: TP-Link_XXXX_5G

• Client Mode

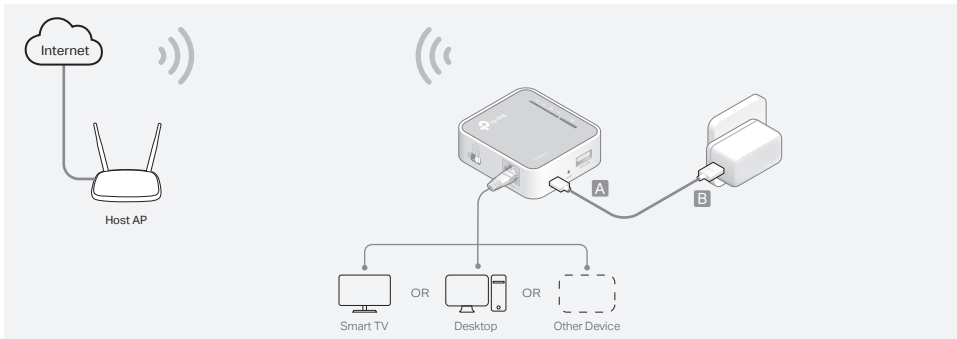

1. Switch the Mode Switch to **AP/Rng Ext/Client** and connect the hardware from Step A to B near your host AP.
2. Connect your device like smartphone, computer or pad to the router wirelessly or via an Ethernet cable. The default SSID (network name) and Wireless Password are printed on the label at the back of the router.

Wireless Password /PIN	XXXXXXXX
SSID	2.4G: TP-Link_XXXX 5G: TP-Link_XXXX_5G

3. Launch a web browser and enter <http://tplinkwifi.net> in the address bar. Create a password to log in.

<http://tplinkwifi.net>

Start

4. Click **Next** to start the Quick Setup, select **Access Point** and then follow the step-by-step web instructions to set up the internet connection.

- Notes:
- You can customize your **Network Name** and **Password** for the 2.4GHz/5GHz wireless network during the Quick Setup, but you need to reconnect your wireless devices to the new Wi-Fi network(s).
 - If you are not sure about the **LAN Type** of the router, use **Smart IP** in most cases.

5. Connect your own devices to the router's Wi-Fi to enjoy the internet. The WAN/LAN port is for connecting to the existing router in this mode.

3. Launch a web browser and enter <http://tplinkwifi.net> in the address bar. Create a password to log in.

<http://tplinkwifi.net>

Start

4. Click **Next** to start the Quick Setup, select **Range Extender** and then follow the step-by-step web instructions to set up the internet connection.

- Notes:
- You can either copy or customize your **SSID** (Network Name) during the Quick Setup. The extended network shares the same Wi-Fi password as that of your host network.
 - If you are not sure about the **LAN Type** of the router, use **Smart IP** in most cases.

5. Relocate the router about halfway between your host AP and the Wi-Fi dead zone.

6. Connect your own device to the router wirelessly or via an Ethernet cable to enjoy the internet. The WAN/LAN port functions as the LAN port in this mode.

3. Launch a web browser and enter <http://tplinkwifi.net> in the address bar. Create a password to log in.

<http://tplinkwifi.net>

Start

4. Click **Next** to start the Quick Setup, select **Client** and then follow the step-by-step web instructions to set up the internet connection.

Note: If you are not sure about the **LAN Type** of the router, use **Smart IP** in most cases.

5. After the setup, connect your wired-only device like smart TV, game console or media player to the router via an Ethernet cable to enjoy the internet. The WAN/LAN port functions as the LAN port in this mode.

Frequently Asked Questions (FAQ)

Q1. What should I do if there is no internet access?

- If you are using a cable modem, unplug the Ethernet cable and reboot the modem. Wait until its Online LED is on and stable, and then reconnect the cable to the modem.
- If you're in a hotel room or on a trade show, the internet may be limited and requires that you authenticate for the service or purchase the internet access.
- If internet access is still unavailable, contact TP-Link Technical Support.

Q2. How do I restore the router to its factory default settings?

- With the router powered on, use a pin to press and hold the **RESET** button until all the LEDs turn off, and then release the button.

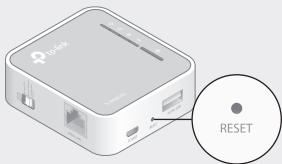

Q3. What should I do if I forget the router's web management password?

- Refer to FAQ > Q2 to reset the router, then create a password to log in.

Q4. What should I do if I forget my Wi-Fi password?

- If you have not changed the default wireless password, it can be found on the label of the router.
- If you have changed the default wireless password, please log in to the router's web management and go to **Wireless 2.4GHz (or Wireless 5GHz) > Wireless Security** to retrieve or reset your password.

Q5. What should I do if my wireless signal is unstable or too weak?

- It may be caused by too much interference.
- Set your wireless channel to a different one.
 - Choose a location with less obstacles that may block the signal between the travel router and the host AP. An open corridor or a spacious location is ideal.
 - Move the router to a new location away from Bluetooth devices and other household electronics, such as cordless phones, microwaves, and baby monitors, to minimize signal interference.
 - In Range Extender mode, the ideal location to place the router is halfway between your host AP and the Wi-Fi dead zone. If that is not possible, place the router closer to your host AP to ensure stable performance.



Safety Information

- Keep the device away from water, fire, humidity or hot environments.
 - Do not attempt to disassemble, repair, or modify the device. If you need service, please contact us.
 - Do not use damaged charger or USB cable to charge the device.
 - Do not use any other chargers than those recommended.
 - Do not use the device where wireless devices are not allowed.
 - Adapter shall be installed near the equipment and shall be easily accessible.
- Please read and follow the above safety information when operating the device. We cannot guarantee that no accidents or damage will occur due to improper use of the device. Please use this product with care and operate at your own risk.

For technical support, replacement services, user guides, and other information, please visit <https://www.tp-link.com/support>, or simply scan the QR code.

To communicate with TP-Link users or engineers, please join the TP-Link Community at <https://community.tp-link.com>.

